



Payne Close
, Crawley, RH10 3UN

Price Guide £350,000



Guide Price £350,000 - £360,000. TMS Estate Agents are pleased to offer for sale this 3 bedroom terraced house in Pound Hill. Much improved by the current owners, including new bathroom, German Klick luxury flooring, Cat6a cabling and gas central heating.

Accommodation is spread across 2 floors and comprises:

GROUND FLOOR

* Entrance Porch: 1.2m x 0.9m (3' 11" x 2' 11")

* Lounge: 4.9m x 4.31m (max) (16' 1" x 14' 2")

* Kitchen / Diner: 4.3m x 2.87m (14' 1" x 9' 5")

FIRST FLOOR

* Landing

* Bedroom 1: 3.76m (exc built-in wardrobes) x 2.69m (12' 4" x 8' 10")

* Bedroom 2: 3.02m (exc built-in wardrobes) x 2.08m (11' 10" x 6' 10")

* Bedroom 3: 2.29m x 2.14m (7' 6" x 7')

* Shower Room: 2.52m x 1.55m (8' 3" x 5' 1")

OUTSIDE

* Garage / Workshop / Utility: 5.06m x 2.37m (16' 7" x 7' 9")

* Rear Garden





Entrance

Lounge

Kitchen/Diner

Bedroom One

Bedroom Two

Bedroom Three

Shower Room

* Garage / Workshop / Utility

Rear Garden



Floor Plan

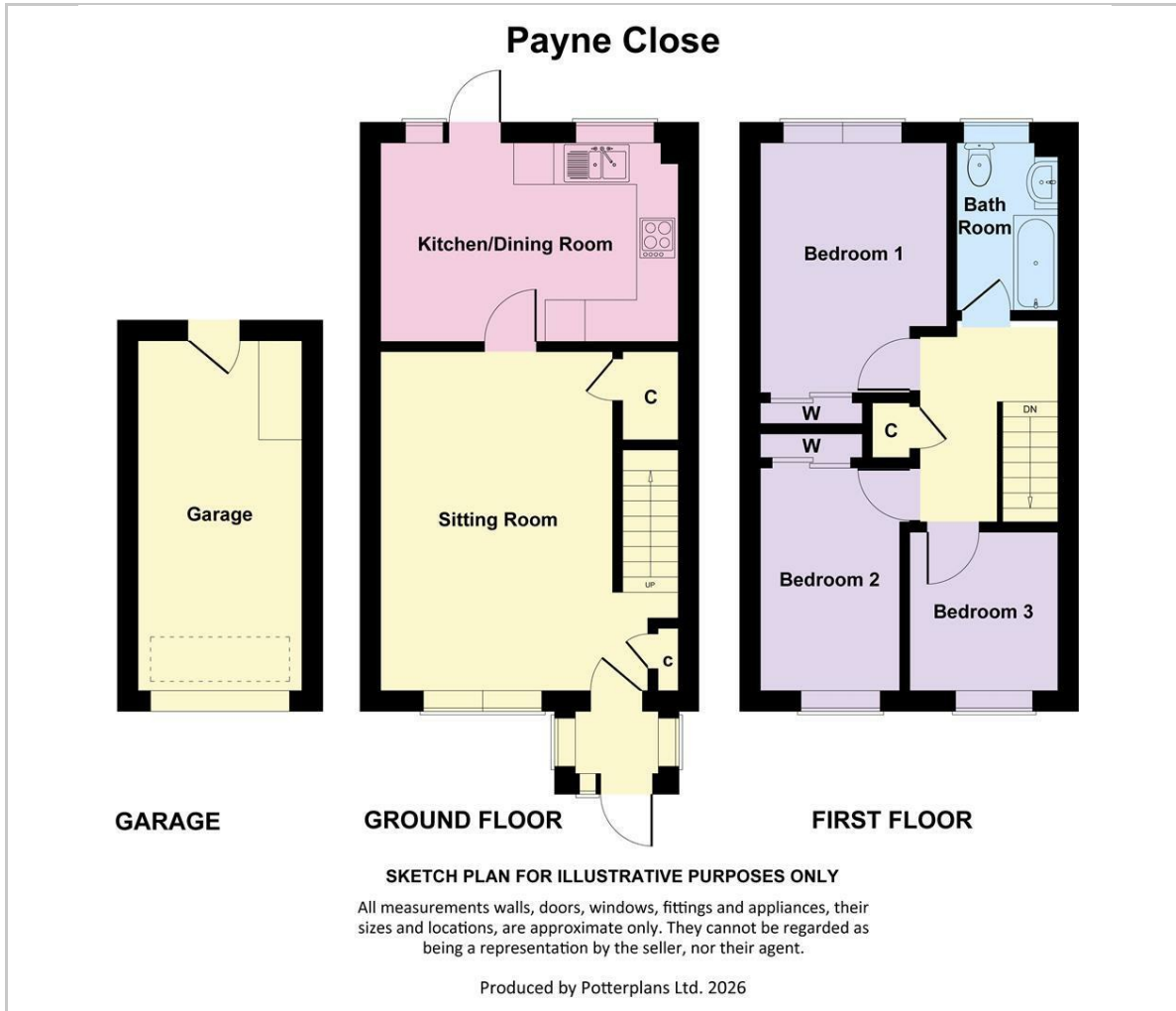

Viewing

Please contact our TMS ESTATE AGENTS Office on 01843 866055 if you wish to arrange a viewing appointment for this property or require further information.

These particulars, whilst believed to be accurate are set out as a general outline only for guidance and do not constitute any part of an offer or contract. Intending purchasers should not rely on them as statements of representation of fact, but must satisfy themselves by inspection or otherwise as to their accuracy. No person in this firms employment has the authority to make or give any representation or warranty in respect of the property.

Kent Innovation Centre Millennium Way, Broadstairs, Kent, CT10 2QQ
t 01843 866055 e info@tmsestateagents.com www.tmsestateagents.com

Area Map

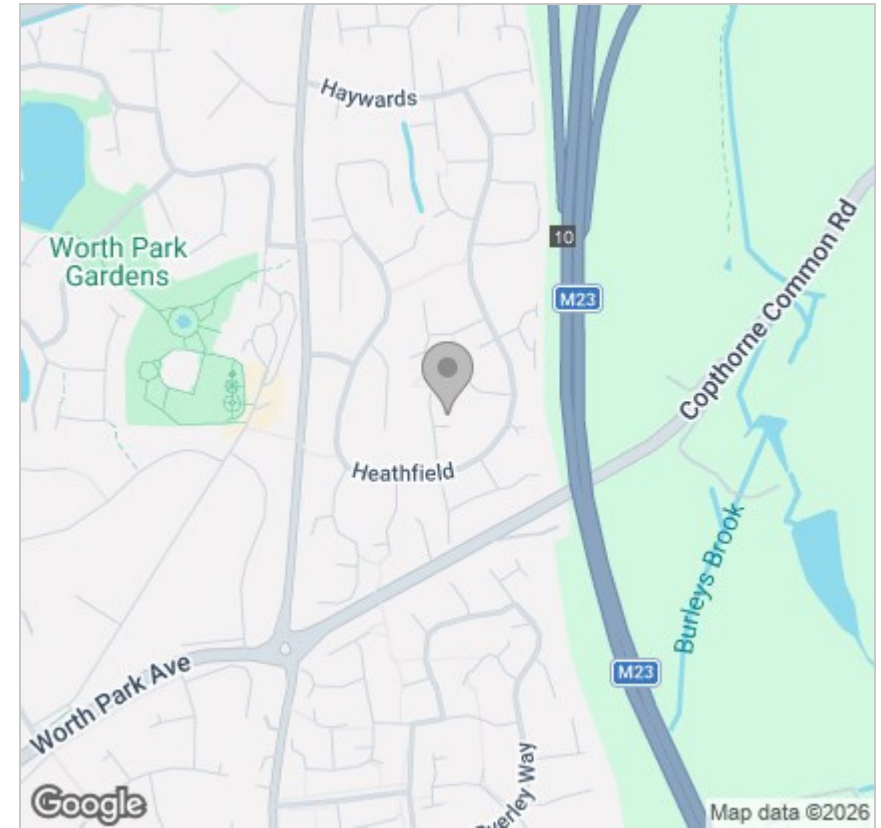

Energy Efficiency Graph

